



How To Use A Herb Tea-phon



HARIO

1

Pour hot water up to the 1 or 2 cup mark of lower bowl, and light the alcohol lamp. (Also works with water.) Set the alcohol lamp in the center of the stand. Adjust the flame to stay under lower bowl. The wick should be about 3mm from the lamp.

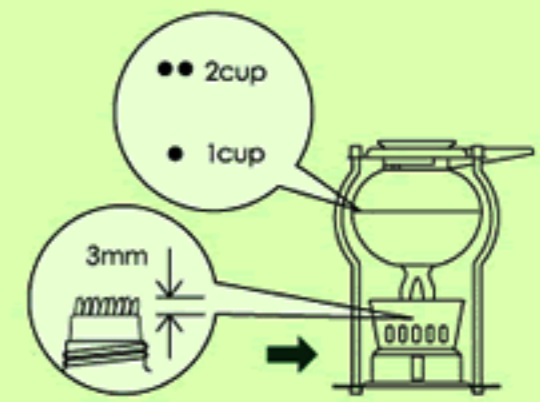

2

Place colander with paper filter in upper bowl, pull chain and secure hook onto the tip of the tube. Pour required amount of servings with measuring spoon into upper bowl.

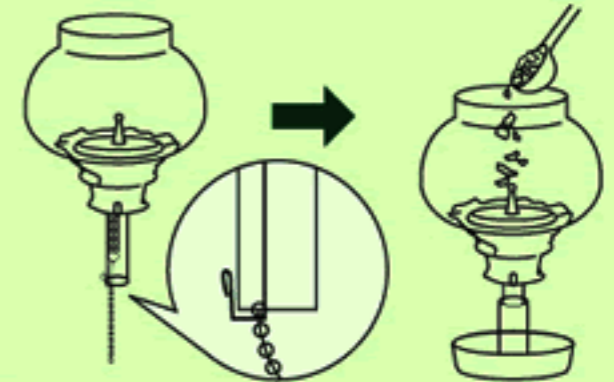

3

Place upper bowl diagonally on the stand (prevents overheating), wait until the water boils, and insert it vertically into the stand.

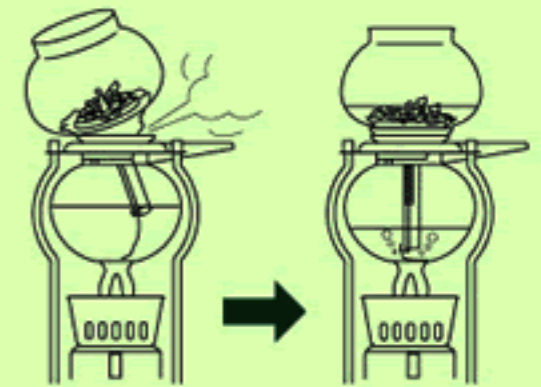

4

When all water from lower bowl rises, stir herbs and water with the other end of measuring spoon and continue heating.

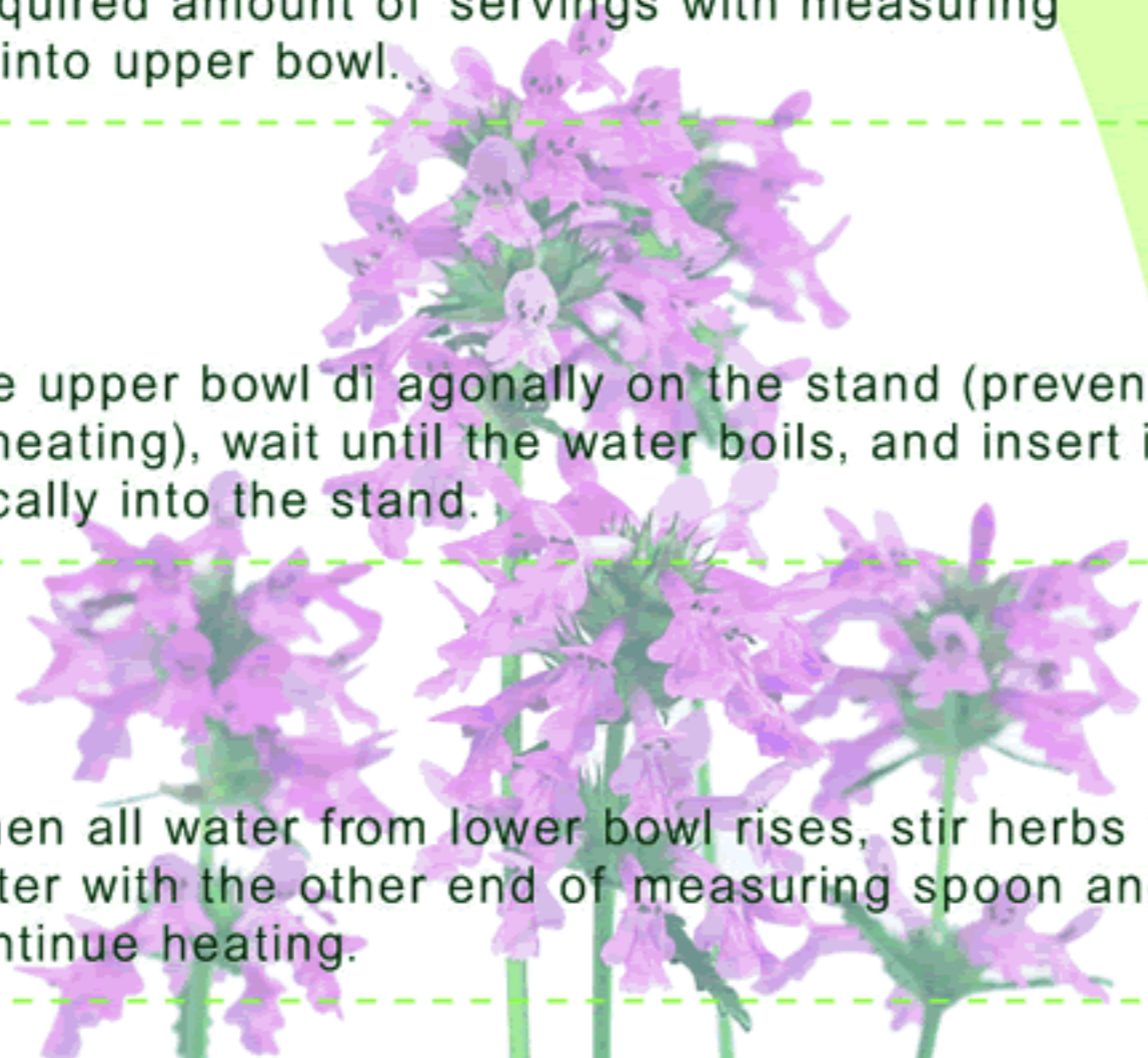

5

When heating time is up, remove the alcohol lamp and lid it to extinguish the flame. Wait for herb tea to descend naturally from upper bowl.

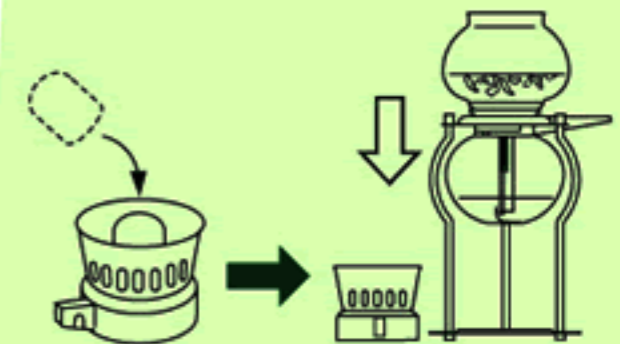

6

When all tea descends into lower bowl, hold handle securely with one hand and carefully tilt upper bowl back and forth to remove. Place it on the lid-cum-stand.

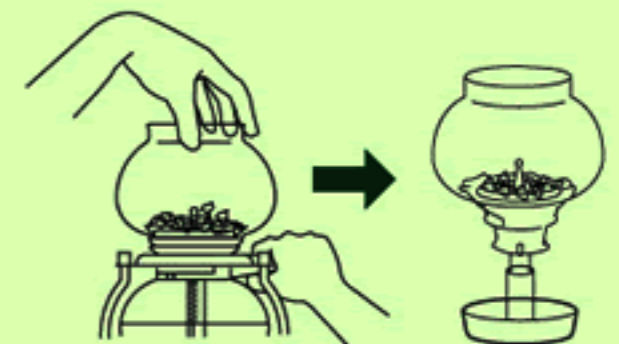

7

Hold stand firmly in one hand and remove lower bowl. Pour tea into your favorite cup and serve. (Tea should be warm enough but if preferred, heat your cup before serving.)

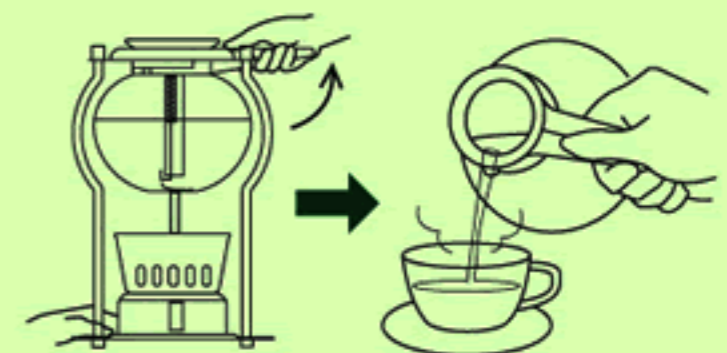

Handling Warnings

- Wipe all traces of water from bowl before heating. When adding water avoid ice-cold water. Do NOT touch the glass portion with wet cloth when hot, or place it on a wet area.
- Do NOT heat when empty.
- Do NOT use abrasive or metallic sponges, or cleansers.
- Do NOT place your face close to the tea-phon when heating. Boiling water may spurt.
- Place lamp in center and keep the flame low.
- Do NOT use for any other purposes